

# ◀ *Sorpasso* ▶

## ***New front hand brake system***

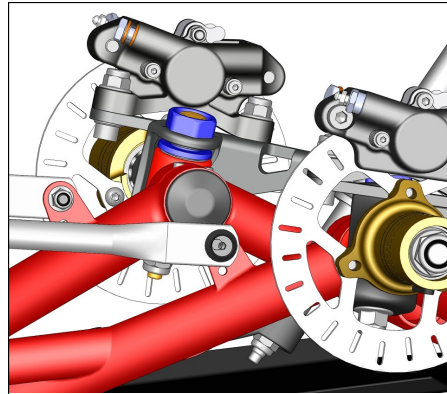
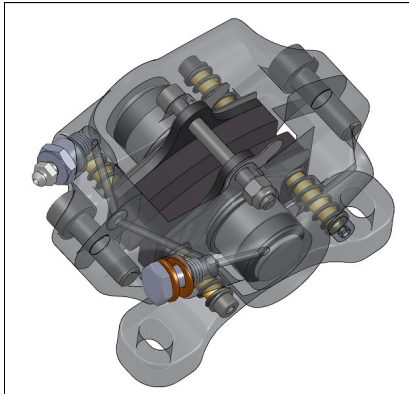

### **features**

- New light weight and low profile design.
- Closed oil line system.
- Use long life thick brake pads.
- Spring pad-return-system offer drag-free and better cool down.
- Caliper is mounted near the king-pin axis line for better handling.
- Radial mount system offer easy to center disc and adapt to mount over sized disc.
- Full CNC-machined magnesium disc/hub carrier.
- Hand master-cylinder can be mounted right or left side.

### **specs**

- Master cylinder bore  $\varnothing 14\text{mm}$
- Caliper bore  $\varnothing 24\text{mm}$  x 2pistons
- Disc stainless steel  $\varnothing 140$  x 3mm
- Disc pad thickness 7mm

